



TOM Temperature Changing

D-Motion dimmable touch switch

Input	12-24Vdc
Output	12-24Vdc
Power	36-72W
Wiring IN	2000mm Micro24 male*
Wiring OUT	2000mm + 150mm 10X Micro24 female*

* For Micro12 connections, request the adaptor cable set.

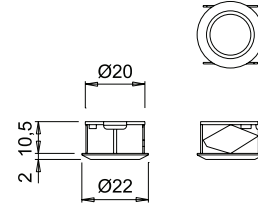

The ON-OFF functions are activated simply with a rapid touch. The brightness is adjusted with a long touch (dimmer function 5-100%) and is then stored until the next adjustment (memory function). The colour temperature of the luminaire connected to the output cable of TOM D-M is selected with three rapid touches (white changeable function).

TOM TEMPERATURE CHANGING

dimmmable touch switch



TOM D-M is a micro touch switch for controlling D-Motion LED luminaires. Designed for recessed installation in a 20 mm diameter and 10.5 mm depth hole, it is connected between the power supply and the lamps (both 12Vdc and 24Vdc). It manages the On and OFF, brightness and colour temperature selection functions. Available in an aluminium finish, it integrates a luminous ring that indicates its operating status.



Aluminium